

Construction notification

22 April 2024

Pier Pavilion

Pier Pavilion, located in Watermans Cove, will be a stunning public space where people can shelter, meet, gather and relax by the water. Infrastructure NSW has engaged Stephen Edwards Constructions (SEC) to deliver the works.

Upcoming works: large vehicle deliveries and pedestrian detours

In the next few weeks, SEC is:

- Undertaking modifications to the public domain area to accommodate steel install and equipment deliveries
- Setting out structural steel columns
- Establishing a mobile crane onsite and commencing mobile crane operations.

There will be some impacts to pedestrians and cyclists during this time (refer to map). Pedestrian movements will be diverted, and cyclists will be asked to dismount for a small section of Wulugul Walk. SEC will provide signage and traffic controllers will be onsite during certain times to assist.

What to expect

Activity	What to expect
Establishment of mobile crane	A mobile crane will be established onsite for the upcoming steel erection period, for approximately 4-5 weeks. It will then be removed from site and substituted with a smaller crane to finish the steel erection process.
Large vehicle deliveries Install structural steel	<ul style="list-style-type: none">• Delivery of supporting equipment, including scissor lifts.• Mobile crane operations to install the steel columns and truss structure.• Large semi-trailer deliveries will occur once every two days during the steel erection period.• During steel deliveries, public exclusion zones will be setup around the perimeter hoarding (refer to map). These exclusion zones will be in place for the duration of semi-trailer movements and unloading and then removed at the end of each day.• Pedestrians and cyclists will be detoured around the exclusion zone, marked by barriers. These zones will be in place for around 4-5 hours every second day.• The smokers' pole and some bike racks will be removed, and bins will be relocated from along Barangaroo Avenue.

Map: Exclusion zones and detours

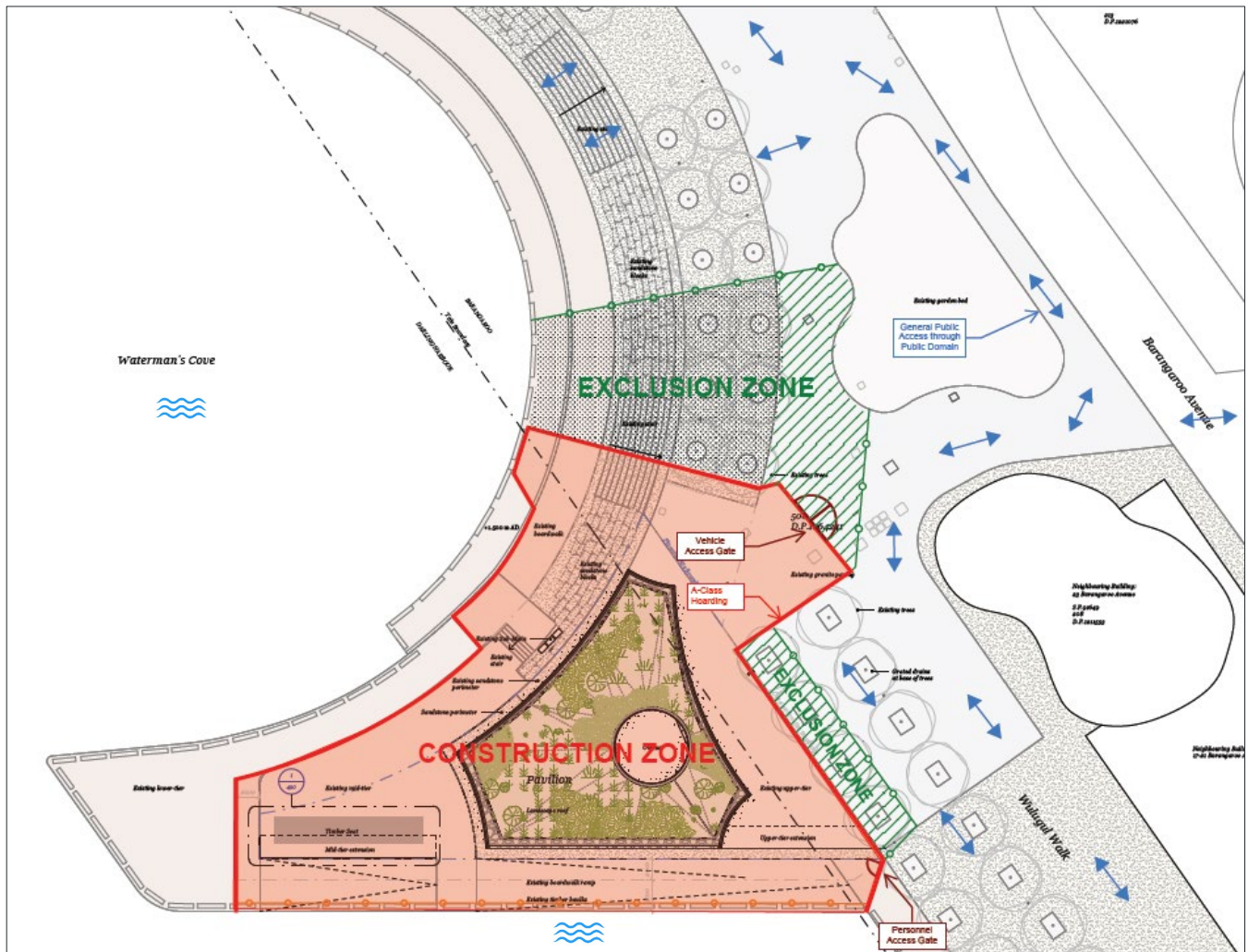

Working hours

Construction will occur during standard City of Sydney construction hours, with an extended respite period from high noise works, detailed below.



Day	Hours of work
Monday to Friday	7.30am - 5.30pm. Respite period: High noise emission appliances*, plant and/or machinery will not be used between 12pm and 2pm.
Saturday	7.30am - 3.30pm. Respite period: High noise emission appliances*, plant and/or machinery will not be used before 9:30am or after 12pm.

*High noise emission appliances include machinery such as piledrivers, rock breakers and hydraulic hammers.

Contact us

We are committed to keeping you informed and regular updates will be provided.

Contact us for construction-related questions, feedback or complaints:

 1800 679 121  barangaroo.info@infrastructure.nsw.gov.au  barangaroo.com

For development updates, [subscribe](#) to the Barangaroo mailing list.

If you need an interpreter, please call Translating and Interpreting Service (TIS) National on 13 14 50 and ask them to call Infrastructure NSW on 1800 679 121 (between 8:30am – 5pm)